

ISO VIEW

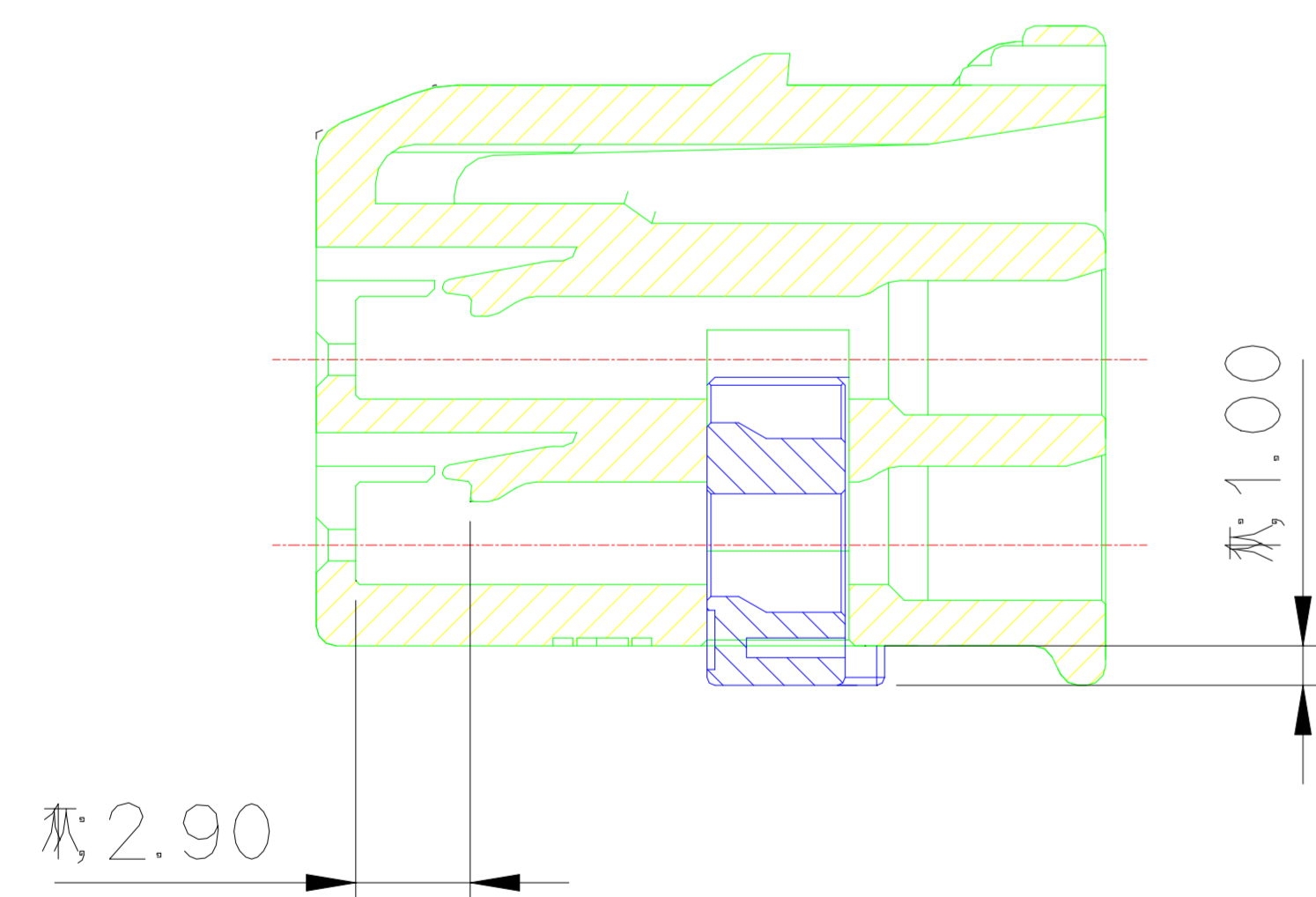
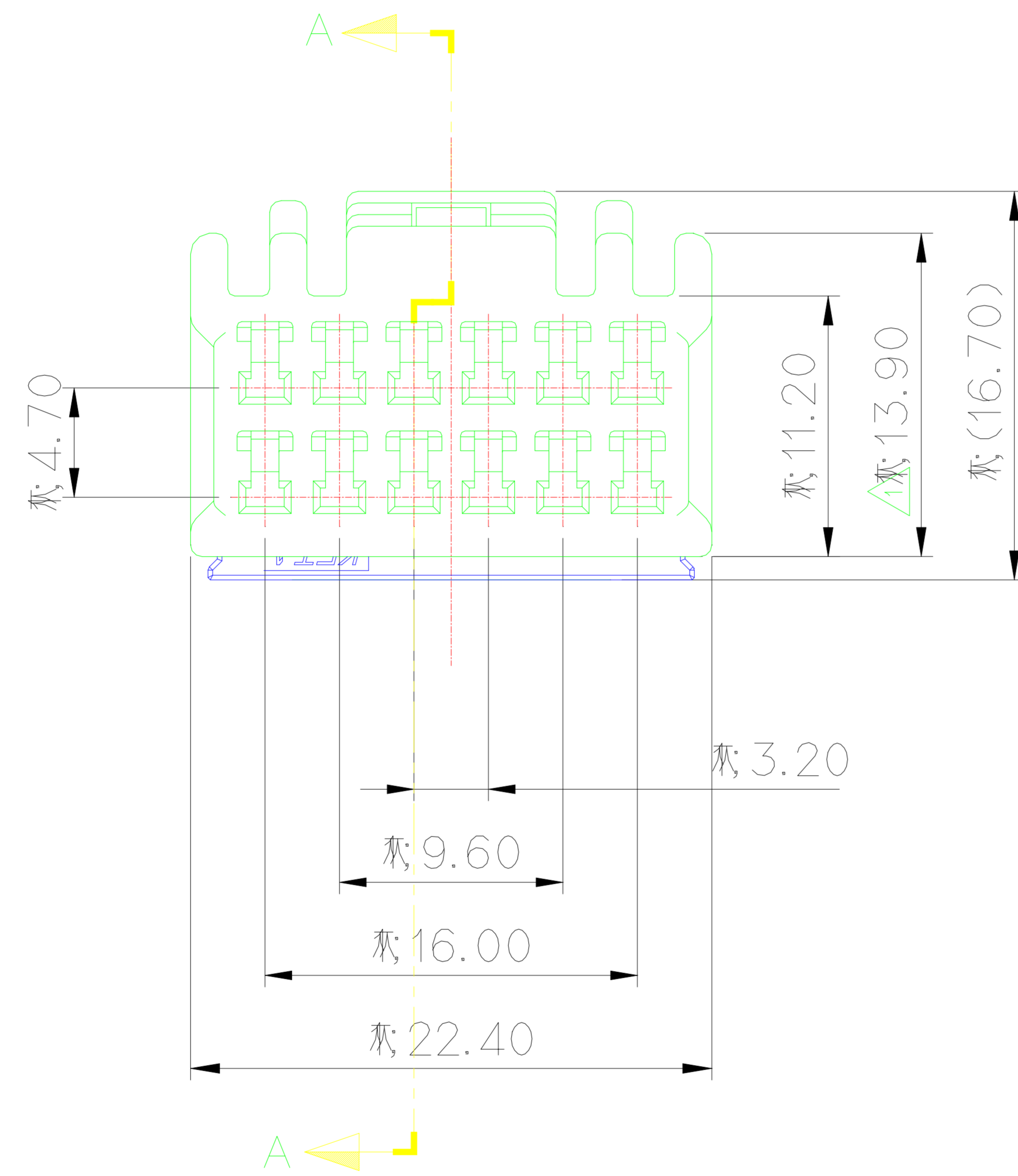
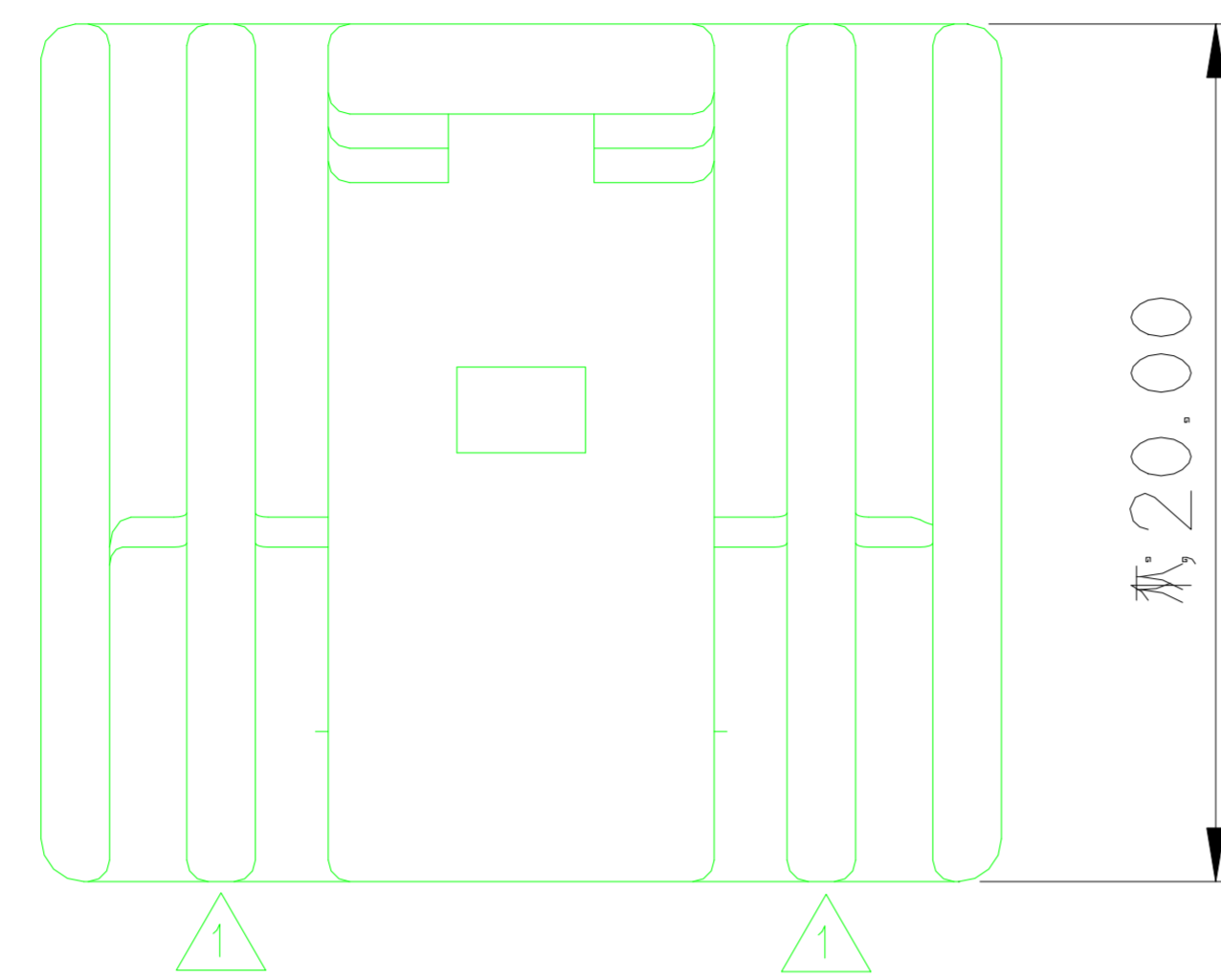

SECTION A-A

GENERAL TOLERANCE (HOUSING)							USED ON
10MAX	50MAX	100MAX	250MAX	250VR	ANGLE	ECCENT	
±0.2	±0.3	±0.55	±0.95	±1.4	±30'	0.1	

NOTE

- MUST BE FREE OF FLASH, WELDLINE AND IMPERFECTION THAT AFFECT FUNCTION.
- APPLICABLE TERMINAL : ST731334-3, ST731335-3, ST731336-3  
APPLICABLE CONNECTOR : MG645610
- 6 HAZARDOUS SUBSTANCES IN PARTS (LEAD, MERCURY, CADMIUM, HEXAVALENT CHROMIUM, PBBs, PBDEs) SHALL NOT EXCEED THE MAXIMUM PERMISSIBLE CONCENTRATION PRESCRIBED UNDER EU ELV DIRECTIVE & RoHS REGULATION.

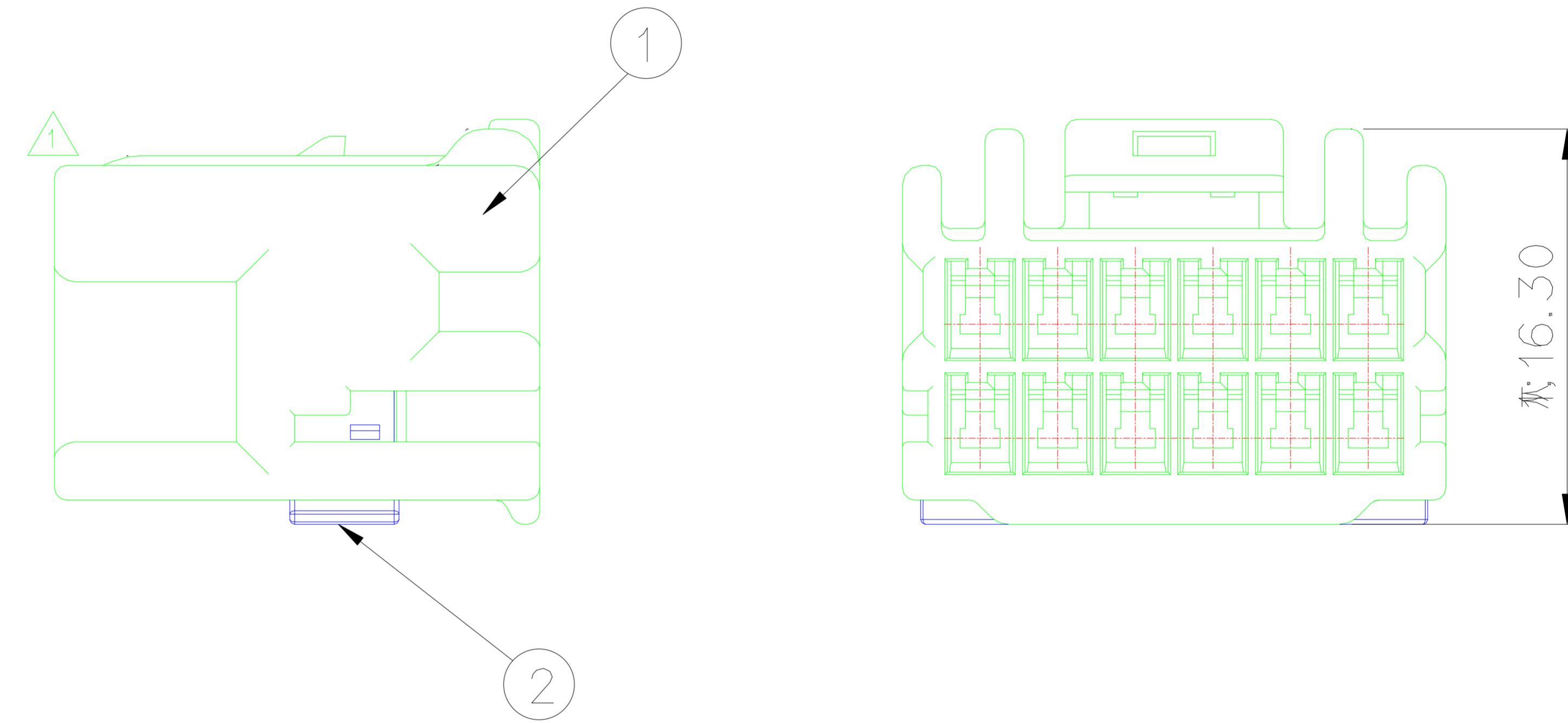

주 기

- 기능상 유해한 BURR 및 WELDLINE 등이 없을 것.
- 적용 TERMINAL : ST731334-3, ST731335-3, ST731336-3  
적용 CONNECTOR : MG645610
- 제품내 함유된 6대 유해물질 (납, 수은, 카드뮴, 6가크롬, PBBs, PBDEs)은 EU ELV 지침 및 RoHS 법규에서 지정한 최대 허용 농도를 초과해서는 안된다.

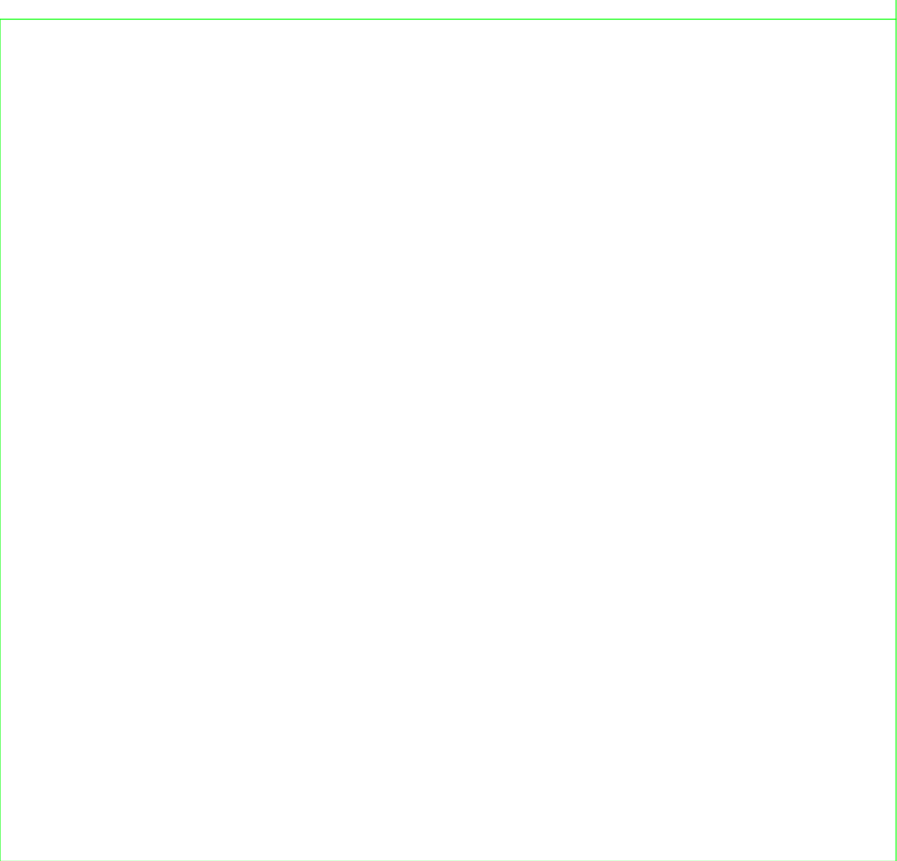

ISSUE MARK

NO.	PART NAME	PART NO.	MATERIAL	COLOR	QTY.
1	N060 12F HOUSING	MG675614	PBT	NATURAL	1
2	N060 12P SPACER	MG675612	PBT	L/GRAY	1

		MATERIAL		SEE TABLE		KOREA ELECTRIC TERMINAL CO., LTD.	
		FINISH		SEE TABLE			
		WIRE RANGE				CLASS 060	
		INSULATION				TYPE	
△ ECO-1209-160 파를 도면 제작성 (MALE TML 간섭 개선)		HSR	CWK	HSH	12.09.27	PART NO. MG655613	
LTR REVISION RECORD		DR.	CHK.	APP.	DATE	SCALE 2/1	
DR. HSR. 2012.09.06		CHK.				PART NAME	
CHK. CWK. 2012.09.06		APP. HSH. 2012.09.06				N060 12F ASSY	
		TOLERANCE EXCEPT AS NOTED		SEE TABLE			