

| GENERAL TOLERANCE (HOUSING) | | | | | | | USED ON |
|-----------------------------|--------|---------|---------|--------|-------|--------|---------|
| 10 MAX | 50 MAX | 100 MAX | 250 MAX | 250 VR | ANGLE | ECCENT | |
| ±0.2 | ±0.3 | ±0.55 | ±0.95 | ±1.4 | ±30' | 0.1 | |

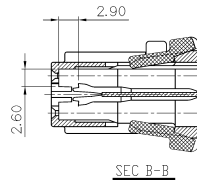
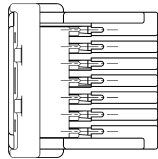
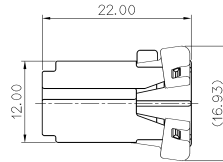
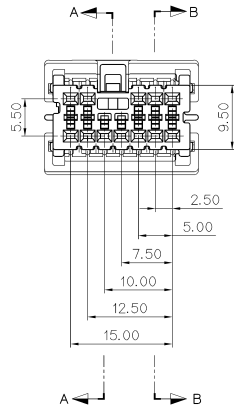
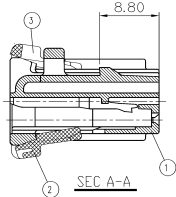
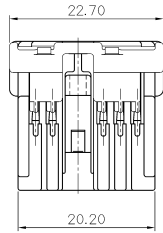

| NO. | PART NO. | PART NAME | MATERIAL | FINISH |
|-----|----------|--------------------------------|----------|---------|
| ① | MG673013 | O40III 12P FEMALE HS'G | PBT | NATURAL |
| ② | MG673014 | O40III 12P FEMALE R/HOLDER (A) | PBT | NATURAL |
| ③ | MG673015 | O40III 12P FEMALE R/HOLDER (B) | PBT | NATURAL |

주 기

1. 기능상 유해한 BURR 및 미성형이 없을것.
2. 상대 HOUSING PART NO. : MG643009
3. 적용 TERM' : ST730770 / ST730960

NOTE

1. MUST BE FREE OF BURR, WELDLINE AND IMPERFECTION THAT AFFECT FUNCTION.
2. APPLICABLE HOUSING : MG643009
3. APPLICABLE TERMINAL : ST730770 / ST730960



ISSUE MARK

| | | | | | | | | | |
|-----|-----------------|-------|------|------|-------|---------------------------------|-------------------------|--|----------|
| | | | | | | MATERIAL | SEE TABLE | KET KOREA ELECTRIC TERMINAL CO., LTD. | |
| | | | | | | FINISH | SEE TABLE | | |
| | | | | | | WIRE RANGE | | CLASS | O40III |
| | | | | | | INSULATION | | TYPE | |
| LTR | REVISION RECORD | DR | CHK | APP. | DATE | TERMINAL DIFFER IN SERIES | SCALE | PART NO. | MG653012 |
| DR | KYM 2004.01.30 | CHK | | | | SEE TABLE | 2/1 | | |
| CHK | 2/2 | 01.30 | APP. | 2/2 | 01.30 | PART NAME | O40III 12P FEMALE ASS'Y | | |