

ISO VIEW

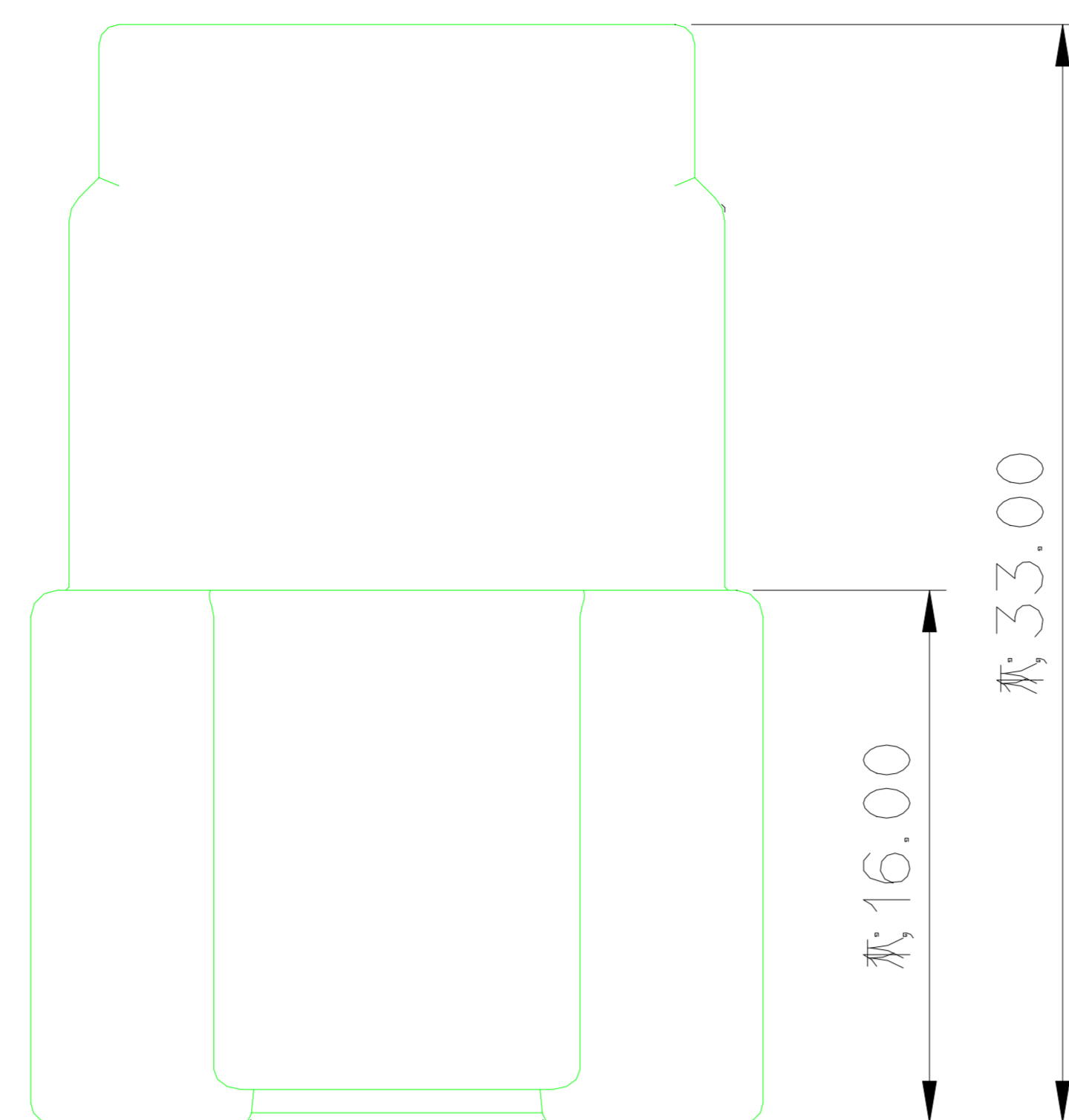

GENERAL TOLERANCE (HOUSING)

10MAX	50MAX	100MAX	250MAX	250VR	ANGLE	ECCENT	USED ON
±0.2	±0.3	±0.55	±0.95	±1.4	±30'	0.1	

NOTE

- MUST BE FREE OF FLASH, WELDLINE AND IMPERFECTION THAT AFFECT FUNCTION.
- APPLICABLE TERMINAL : ST741331-3, ST741332-3, ST741333-3
APPLICABLE CONNECTOR : MG655608
- 6 HAZARDOUS SUBSTANCES IN PARTS (LEAD, MERCURY, CADMIUM, HEXAVALENT CHROMIUM, PBBs, PBDEs) SHALL NOT EXCEED THE MAXIMUM PERMISSIBLE CONCENTRATION PRESCRIBED UNDER EU ELV DIRECTIVE & RoHS REGULATION.

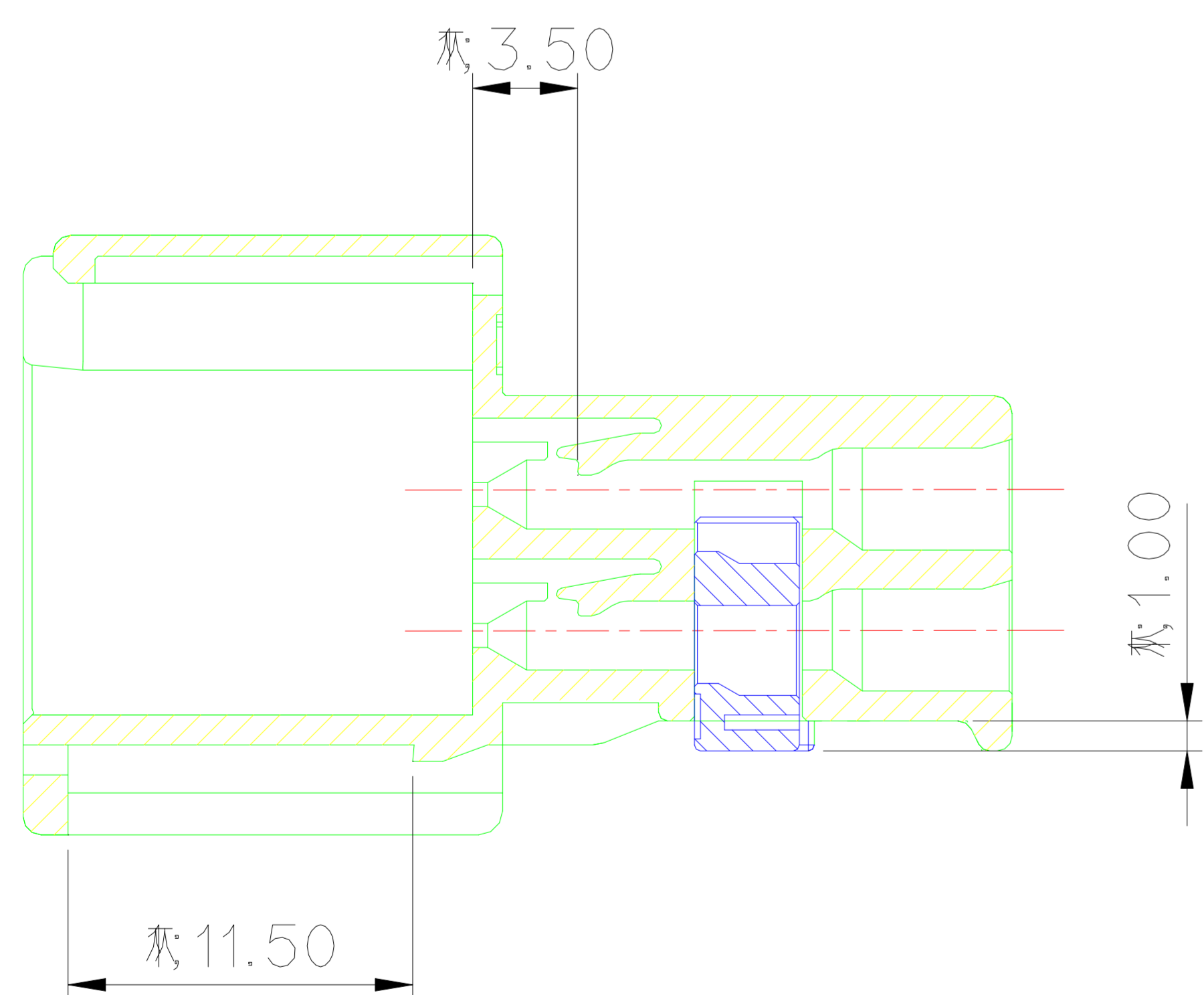
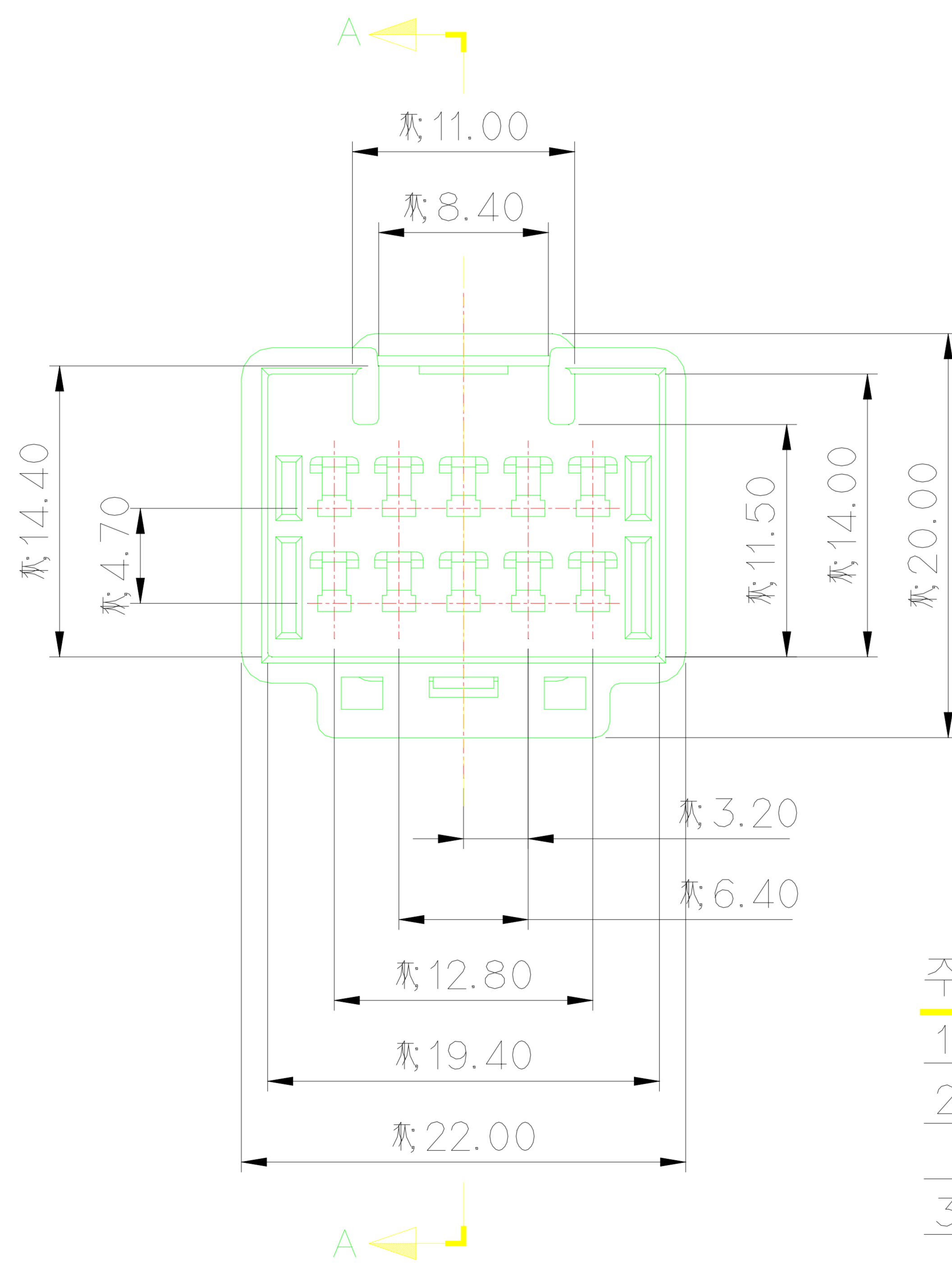

SECTION A-A

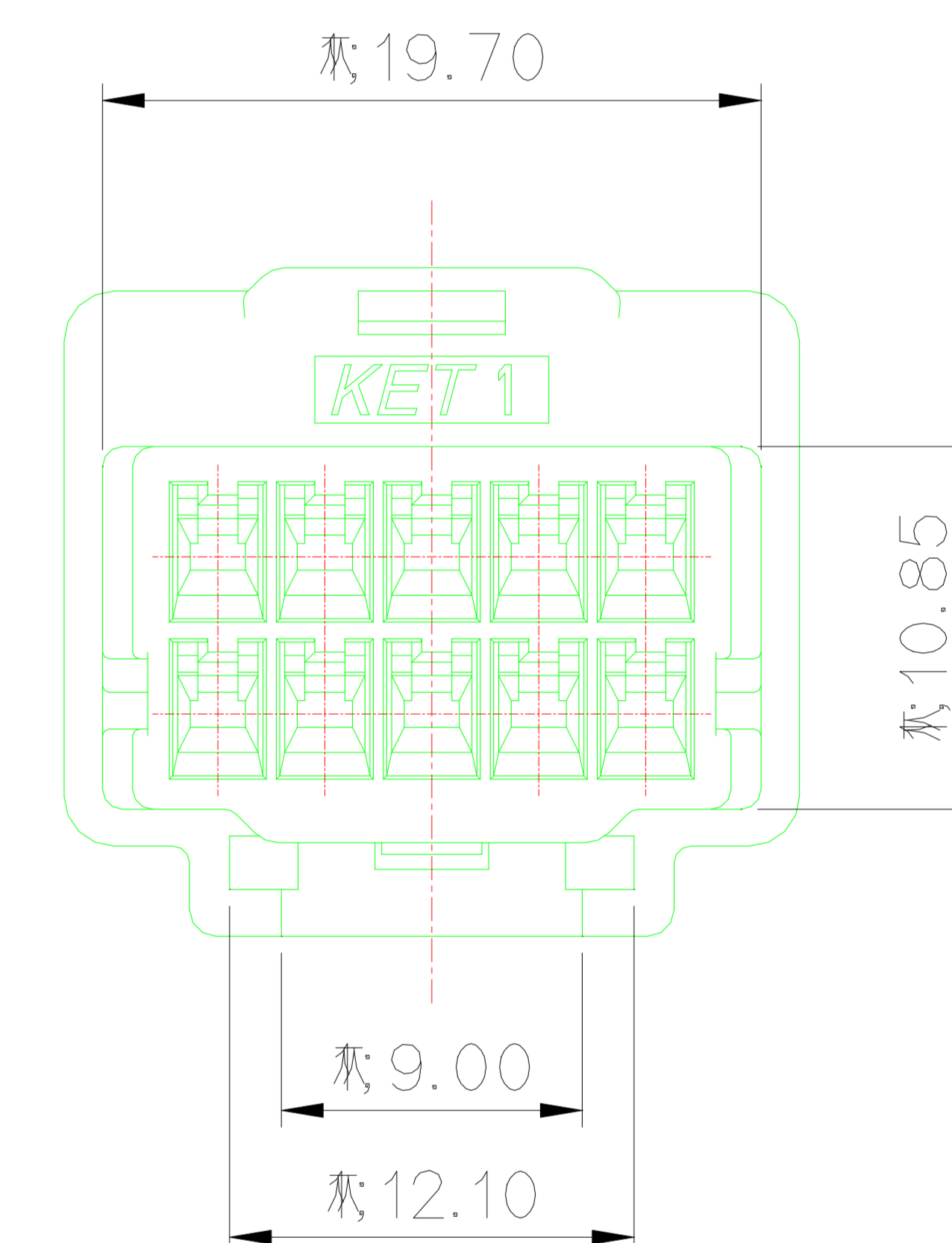
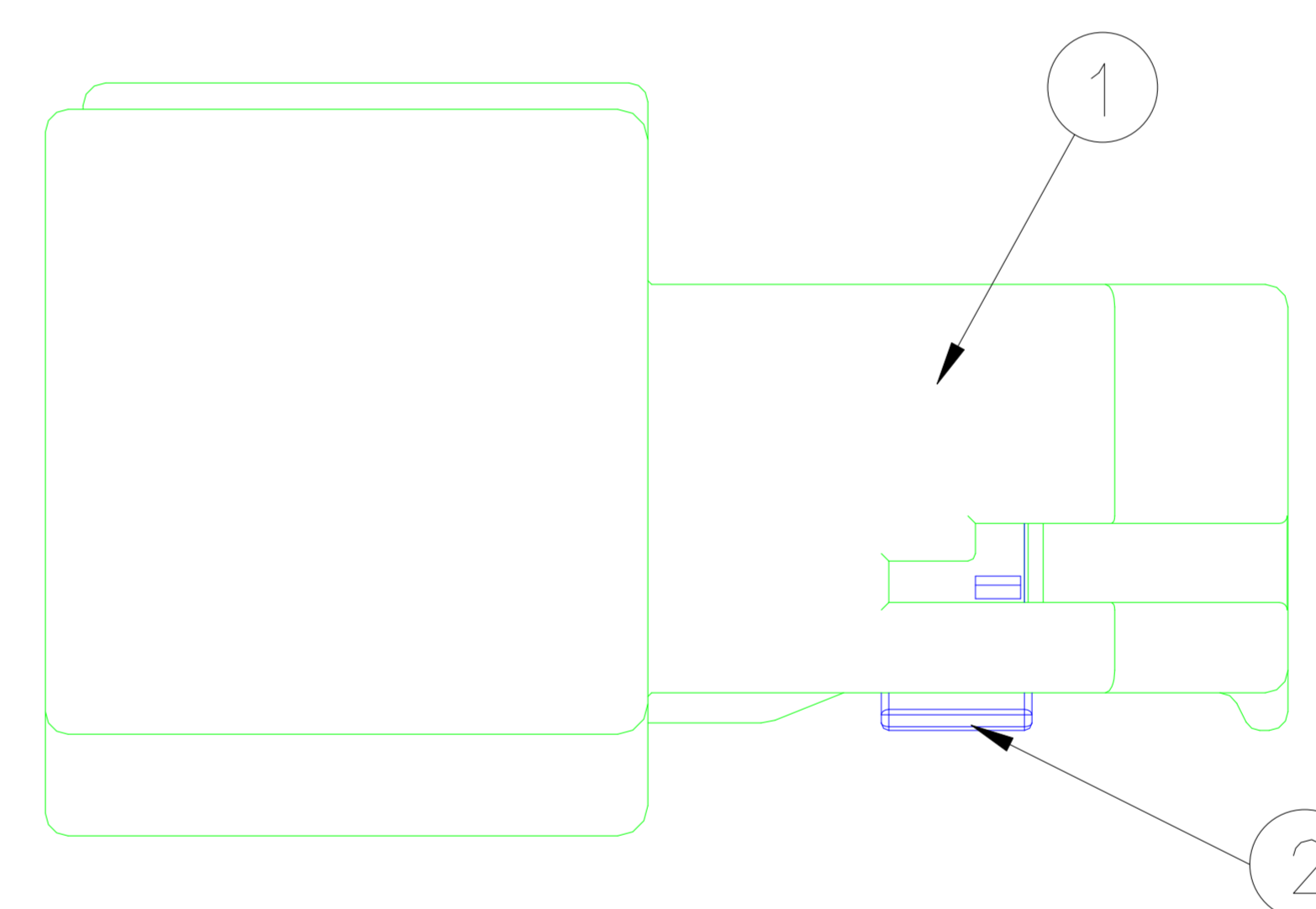

주 기

- 기능상 유해한 BURR 및 WELDLINE 등이 없을 것.
- 적용 TERMINAL : ST741331-3, ST741332-3, ST741333-3
적용 CONNECTOR : MG655608
- 제품내 함유된 6대 유해물질 (납, 수은, 카드뮴, 6가크롬, PBBs, PBDEs)은 EU ELV 지침 및 RoHS 법규에서 지정한 최대 허용 농도를 초과해서는 안된다.

ISSUE MARK

NO.	PART NAME	PART NO.	MATERIAL	COLOR	QTY.
1	N060 10M HOUSING	MG675606	PBT	NATURAL	1
2	N060 10P SPACER	MG675607	PBT	L/GRAY	1

				MATERIAL	SEE TABLE	KET KOREA ELECTRIC TERMINAL CO., LTD.		
				FINISH	SEE TABLE			
				WIRE RANGE		CLASS 060		
				INSULATION		TYPE		
LTR	REVISION RECORD	DR.	CHK.	APP.	DATE	TOLERANCE EXCEPT AS NOTED	SCALE 2/1	PART NO. MG645605
DR.	AJH. 2012.02.14	CHK.	KMH.	2012.02.16		SEE TABLE		
CHK.	CSH. 2012.02.16	APP.	HSH.	2012.02.16		PART NAME	N060 10M ASSY	