

PART NO. SEE TABLE

CUSTOMER DRAWING

NO.	ASSY NO.	구성품					Q'TY
		NO.	PART NAME	PART NO	MATERIAL	FINISH	
1	MG644088	①	025 28M PCB HOUSING	MG674089-0	PBT+GF10%	NATURAL	1 EA
				MG674089-5		BLACK	
				MG674089-41		LIGHT GRAY	
		②	025 PCB BANDOLIER PIN	ST792300-3	BRASS	PRE-TIN	28 EA
2	MG645119	①	025 28M PCB HOUSING	MG675120	PBT+GF10%	NATURAL	1 EA
				ST792300-2		BRASS	
		②	025 PCB BANDOLIER PIN	ST792300-2	BRASS	Sn 후도금	28 EA

GENERAL TOLERANCE (TERMINAL)					GENERAL TOLERANCE (HOUSING)							USED ON
10MAX	20MAX	45MAX	ANGLE	ECCENT	10MAX	50MAX	100MAX	250MAX	250VR	ANGLE	ECCENT	
±0.2	±0.25	±0.3	±30'	0.1	±0.2	±0.3	±0.55	±0.95	±1.4	±30'	0.1	

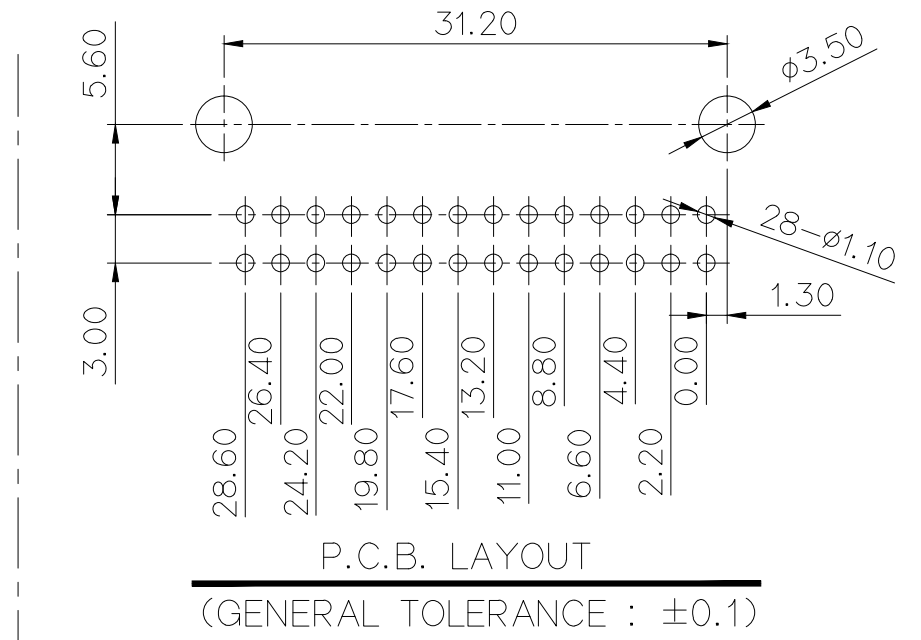
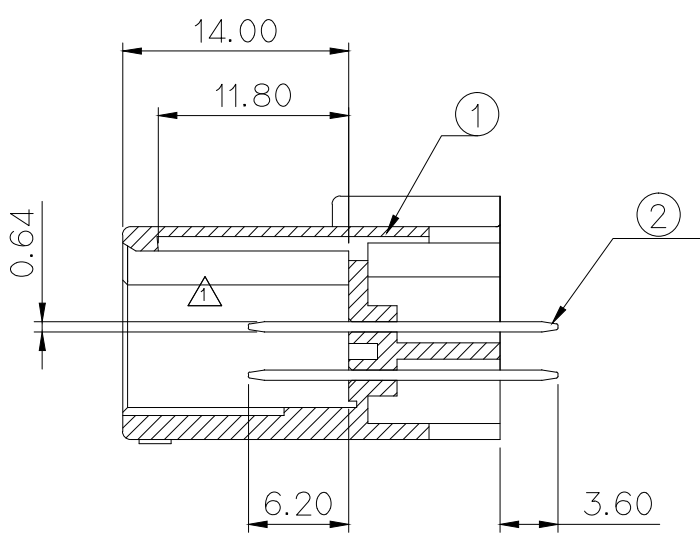
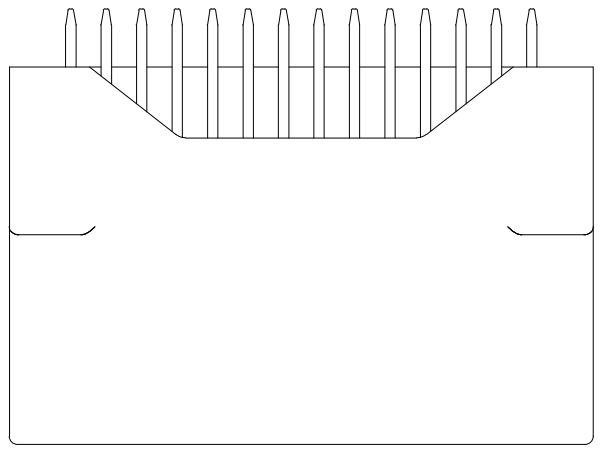

SECTION A-A

P.C.B. LAYOUT  
(GENERAL TOLERANCE : ±0.1)

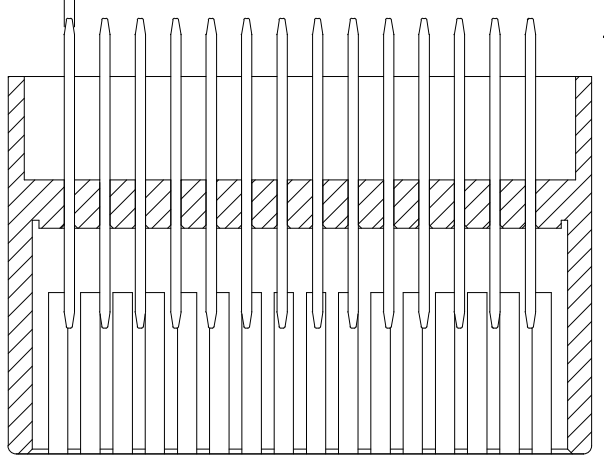
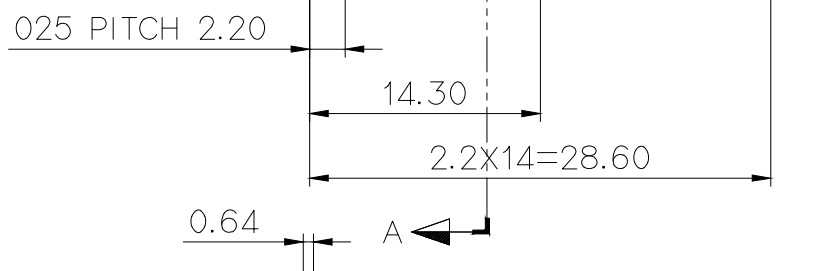
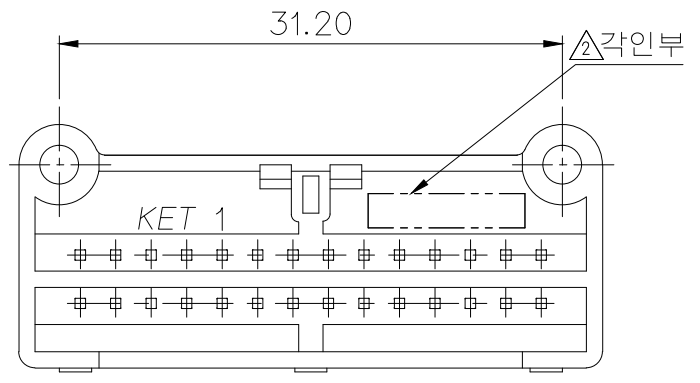
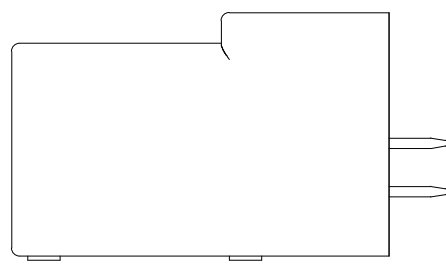
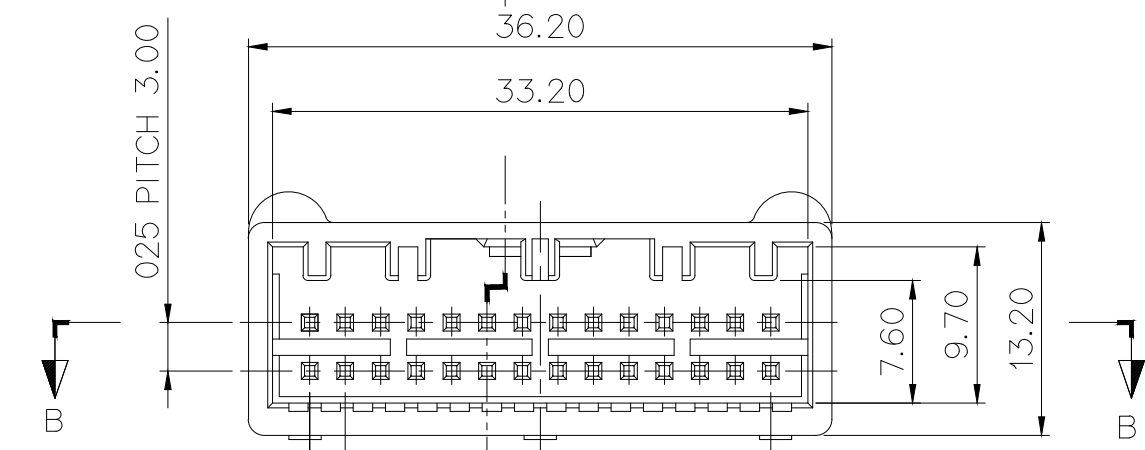

SECTION B-B

주 기

- 기능상 유해한 BURR 및 WELDLINE 등이 없을 것.
- 적용 HOUSING : MG654090, MG655762
- 적용 BOLT : M3 일반나사
- 제품내 함유된 10대 유해물질 (납,수은,카드뮴,6가크롬, PBBs, PBDEs, DHEP, DBP, BBP, DIBP)은 EU ELV 지침 및 RoHS 법규에서 지정한 최대 허용 농도를 초과해서는 안된다.

NOTE

- MUST BE FREE OF BURR, WELDLINE AND IMPERFECTION THAT AFFECT FUNCTION.
- APPLICABLE HOUSING : MG654090, MG655762
- APPLICABLE MOUNTING SCREW : M3 SCREW
- 10 HAZARDOUS SUBSTANCES IN PARTS (LEAD MERCURY, CADMIUM, HEXAVALENT CHROMIUM, PPBs, PPDEs, DHEP, DBP, BBP, DIBP) SHALL NOT EXCEED THE MAXIMUM PERMISSIBLE CONCENTRATION PRESCRIBED UNDER EU ELV DIRECTIVE & RoHS REGULATION.

**APPROVED**  
2021-10-20  
KOREA ELECTRIC  
TERMINAL CO., LTD.  
Korea Electric Terminal Co., LTD.

ISSUE MARK

LTR	REVISION RECORD	DR.	CHK.	APP.	DATE

MATERIAL	SEE TABLE	KETA KOREA ELECTRIC ENGINEERED TERMINAL CO., LTD.
FINISH	SEE TABLE	
WIRE RANGE		CLASS 025
INSULATION		TYPE
TOLERANCE EXCEPT AS NOTED	SEE TABLE	SCALE 2/1
PART NAME	025 28M PCB CONNECTOR (VRT)	

DIMENSIONS IN (MM)