

SECTION A-A

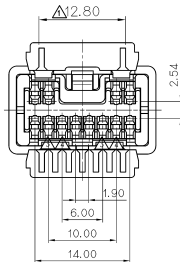
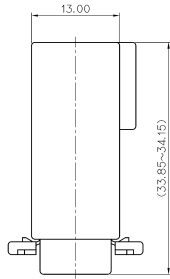
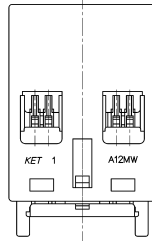
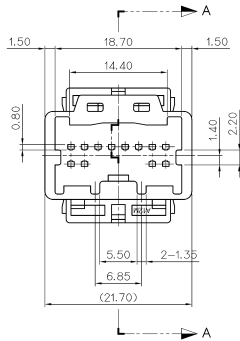

GENERAL TOLERANCE (HOUSING)								USED ON
10MAX	50MAX	100MAX	250MAX	250VR	ANGLE	ECCENT		
±0.20	±0.3	±0.55	±0.95	±1.4	±30'	0.10		

주 기

1. 기능상 유해한 BURR 및 미성형이 없을것.
2. 상대 HOUSING PART NO. : MG651397
- △ 3. 적용 TERMINAL NO. : ST740928, 929
- △ 4. 제품내 함유된 6대 유해물질 (납,수은,카드뮴,6가크롬,PBBs, PBDEs)는 EU ELV 지침 및 RoHS법규에서 지정한 최대 허용 농도를 초과해서는 안된다.

NOTE

1. MUST BE FREE OF FLASH, SINK AND IMPERFECTION THAT AFFECT FUNCTION.
2. APPLICABLE HOUSING NO. : MG651397
- △ 3. APPLICABLE TERMINAL NO. : ST740928, 929
- △ 4. HAZARDOUS SUBSTANCES IN PARTS(LEAD,MERCURY,CADMIUM, HEXAVALENT CHROMIUM,PBBs,PBDEs) SHALL NOT EXCEED THE MAXIMUM PERMISSIBLE CONCENTRATION PRESCRIBED UNDER EU ELV DIRECTIVE & RoHS REGULATION.

NO.	PART NO.	PART NAME	MATERIAL	FINISH
1	MG671392	A 12M HOUSING	PBT	NATURAL
2	MG671393	A 12M REAR HOLDER	NYLON66	NATURAL



ISSUE MARK

△ 1. 부품명(S03010205) 과의 다른 제품명 (LOCAR HOLDER HINGE용 용기) △ 2. 부품명(S03010277) 과의 다른 제품명 (LOCAR HOLDER HINGE용 용기) △ 3. 부품명(S03000003) 과의 다른 제품명 (기타, 수직형 용기 용기 TALL 용기) △ 4. 사양명(S0301035) 과의 다른 제품명	CDH YSW KND CCW	07.11.22 07.05.22 '06.01.05 '03.7.24	MATERIAL SEE TABLE FINISH SEE TABLE WIRE RANGE INSULATION	KET KOREA ELECTRIC TERMINAL CO., LTD. CLASS TYPE 7282-4125 PART NO. MG641394
LTR REVISION RECORD DR. BIN. '02.03.04 CHK.	DR CHK APP DATE APP. CHW 3/5	2/1 SCALE PART NAME A 12M HOUSING ASSY (A12MW)		