

GENERAL TOLERANCE (HOUSING)					USED ON
10MAX	20MAX	45MAX	ANGLE	ECCENT	
±0.2	±0.25	±0.3	±30'	0.1	

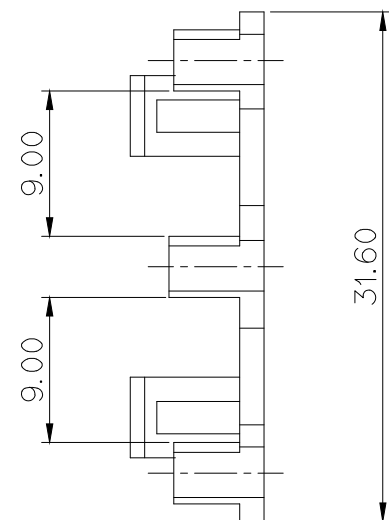
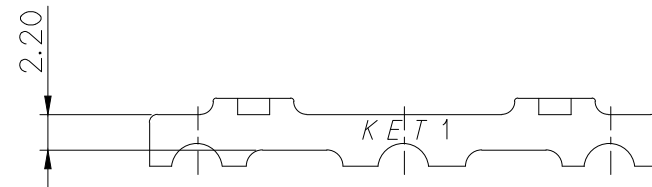
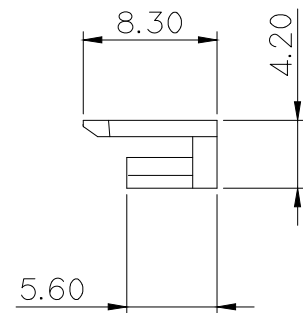
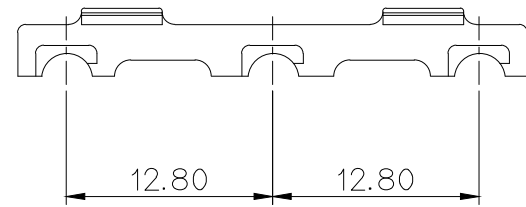
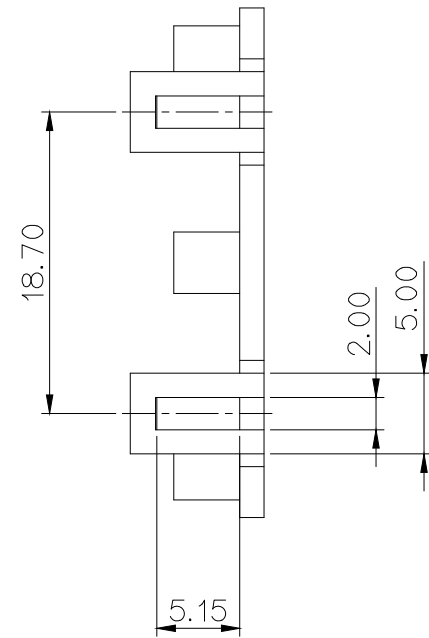

주 기

- 기능상 유해한 BURR, WELDLINE이 없을 것
- 적용 HOUSING : MG613212
- 제품내 함유된 6대 유해물질 (납,수은,카드뮴,6가크롬, PBBs,PBDEs)은 EU ELV 지침 및 RoHS 법규에서 지정한 최대 허용 농도를 초과해서는 안된다.

NO.	MATERIAL	COLOR
0	PA66	NATURAL
1		RED
2		BLUE
3		YELLOW
5		BLACK

NOTE

- MUST BE FREE OF BURR, WELDLINE AND IMPERFECTION THAT AFFECT FUNCTION.
- APPLICABLE HOUSING: MG613212
- 6 HAZARDOUS SUBSTANCES IN PARTS (LEAD, MERCURY, CADMIUM, HEXAVALENT CHROMIUM, PBBs, PBDEs) SHALL NOT EXCEED THE MAXIMUM PERMISSIBLE CONCENTRATION PRESCRIBED UNDER EU ELV DIRECTIVE & RoHS REGULATION.

**APPROVED**

**2016-03-10**

**KOREA ELECTRIC  
TERMINAL CO., LTD.  
Electronic Product Development Team**

ISSUE MARK

		MATERIAL $\Delta$ PA66 (V0)		<b>KET</b> KOREA ELECTRIC ENGINEERED TERMINAL CO., LTD.				
		FINISH RED						
		WIRE RANGE		CLASS 060				
		INSULATION		TYPE				
LTR	REVISION RECORD	DR.	CHK.	APP.	DATE	TOLERANCE EXCEPT AS NOTED	SCALE	PART NO.
	KSH. 2007.01.21				1/31	SEE TABLE	2/1	MG633861
CHK.		APP.	C B H		PART NAME 060 3P R/H			