

△ GENERAL TOLERANCE (HOUSING)										USED ON
10MAX	30MAX	50MAX	70MAX	100MAX	120MAX	250MAX	250VR	ANGLE	ECCENT	MG611271
±0.15	±0.20	±0.30	±0.40	±0.50	±0.75	±0.90	±1.4	±0.5'	0.1	

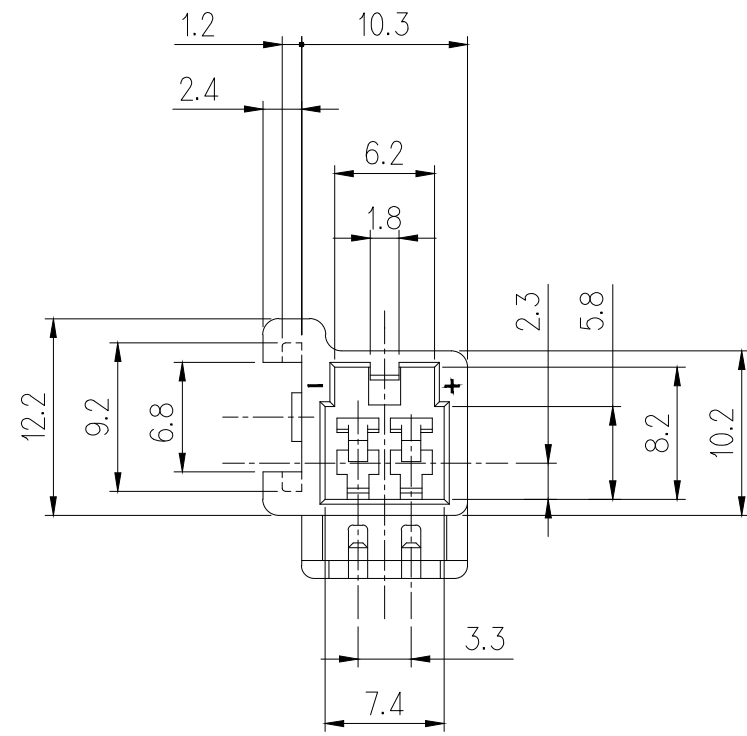

△ NO.	MATERIAL	COLOR
0	P B T:	NATURAL
1		RED
2		BLUE
20		JADE
3		YELLOW
4		GRAY
40		DARK GRAY
41		LIGHT GRAY
5		BLACK
6		DARK GREEN
* 7		BROWN
8	LIGHT GREEN	
9	MAGENTA	
11	ORANGE	

주 기

1. 기능상 유해한 BURR 및 WELDLINE 등이 없을것.
2. 적용 TAB TERMINAL : ST740719,720 (7114-1300,1301).
3. 적용 PLUG HOUSING : MG611271(7123-7822)
4. 제품내 함유된 6대 유해물질 (납,수은,카드뮴,6가크롬, PBBs,PBDEs)은 EU ELV 지침 및 RoHS 법규에서 지정한 최대 허용 농도를 초과해서는 안된다.

NOTE

1. MUST BE FREE OF BURR, WELDLINE AND IMPERFECTION THAT AFFECT FUNCTION.
2. APPLICABLE TERMINAL : ST740719,720 (7114-1300,1301).
3. APPLICABLE PLUG HOUSING : MG611271(7123-7822)
4. 6 HAZARDOUS SUBSTANCES IN PARTS (LEAD MERCURY,CADMIUM,HEXAVALENT CHROMIUM, PPBs,PPDEs) SHALL NOT EXCEED THE MAXIMUM PERMISSIBLE CONCENTRATION PRESCRIBED UNDER EU ELV DIRECTIVE & RoHS REGULATION.



ISSUE MARK

		MATERIAL		SEE NOTE	KOREA ELECTRIC TERMINAL CO., LTD.
		FINISH		SEE NOTE	
		WIRE RANGE		CLASS	62C(.060)
		INSULATION		TYPE	7122-7822
△	ECO-1710-203 근거 도면 작성 (공차 테이블 변경 및 색상표 추가)	KJC	HYJ	CJH	17.10.24
LTR	REVISION RECORD	DR.	CHK.	APP.	DATE
DR. MAN '97.03.14.		CHK. K.K.J		J.J.H	11/14
CHK. JANG		APP. WATANABE			11/20
		TOLERANCE EXCEPT AS NOTED		SCALE	2/1
		PART NAME		62C 2P REC HS'G	
				PART NO.	MG621386