

NO.	MATERIAL	COLOR
0		NATURAL
1		RED
2		BLUE
3	PBT	YELLOW
4		GRAY
5		BLACK
6		WHITE GREEN
7		BROWN
8		GREEN

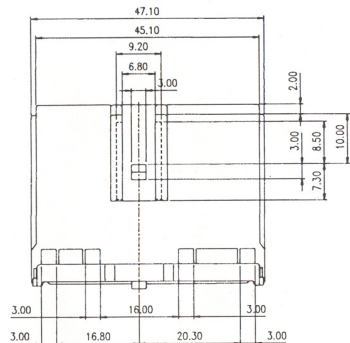
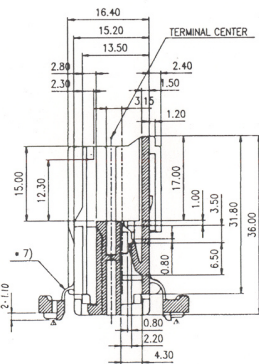
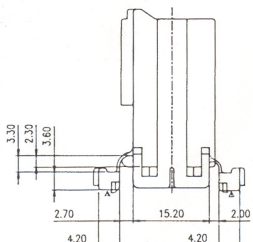
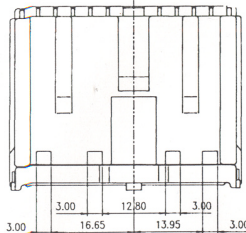
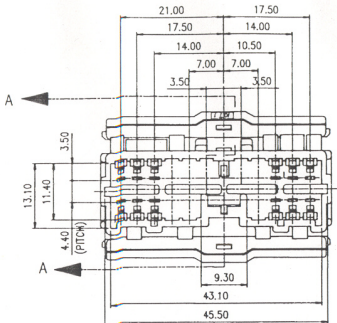

- 주 기
1. 지시하지 않은 R은 0.5 원.
 2. 비 치는 10(g/10 분) 이하 일 것
 3. 적용 TERMINAL: ST 740484, ST 740485
YAZAKI P/NO: 7114-1470, 7114-1475
 4. 호우 HOUSING P/NO: MG 610410
 5. CONNT ASSY 삽입력: 14kgf 이하
 6. 만자 고착액(LANCE) 잔류: 6 kgf 이상, (총합: 10kgf 이상)
 7. HINGE 부에 BURR, 이물질, 먼지, WELD LINE 등의 결함이 없을 것.
- HINGE 쪽은 10회 이상 반복 굽힘 시험 후 CRACK 발생이 없을 것
(시험 온도: 20°C)

SEC. A-A

DETAIL CAVITY (5/1)

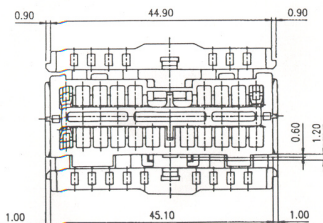
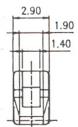

CUSTOMER DRAWING

DATE	REV	BY	CHK	DATE	REV	BY	CHK	DATE	REV	BY	CHK
SEE TABLE SEE TABLE SEE TABLE				KET KOREA ELECTRIC TERMINAL CO. LTD				NO CLASS NO. TYPE: 122-8306			
LTR = 3 REVISION RECORD				DATE				SCALE 2/1			
DR. SIK 92.12.21				DATE				NO. MG 620411			
CHK. S. L. P.				DATE				NO.			
SDL CONNECTOR 20P REC HOUSING											