

GENERAL TOLERANCE (HOUSING)					USED ON
10MAX	20MAX	45MAX	ANGLE	ECCENT	
±0.2	±0.25	±0.3	±30'	0.1	

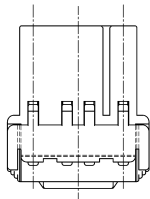

NOTE

- 1.지시하지 않은 반경 R은 0.3로 한다.
- 2.기능상 유해한 BURR 및 WELDLINE등이 없을것.
- 3.적용 REC TERMINAL: ST730703, 704

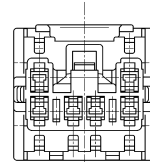
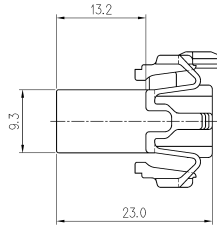
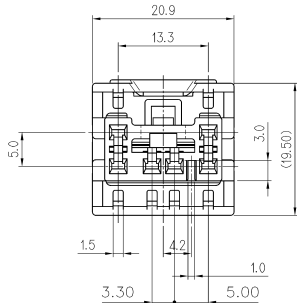
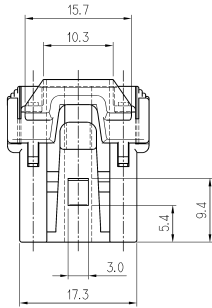

ISSUE MARK

		MATERIAL		SEE NOTE	KOREA ELECTRIC TERMINAL CO., LTD.		
		FINISH		SEE NOTE			
		WIRE RANGE		CLASS .620(I060)			
		INSULATION		TYPE 7123-7861			
LTR	REVISION RECORD	DR	CHK	APP	DATE	SCALE 2/1	PART NO. MG611276
DR	MAN '97.8.30	CHK	<i>[Signature]</i>	APP	9/9		
CHK	<i>[Signature]</i>	APP	<i>[Signature]</i>	APP	9/9	PART NAME	C 6P PLUG HS'G (BLACK)