

NO.	MATERIAL	COLOR
0	P B T	NATURAL
1		RED
2		BLUE
20		JADE
3		YELLOW
4		GRAY
40		DARK GRAY
41		LIGHT GRAY
5		BLACK
6		DARK GREEN
7		BROWN
8		LIGHT GREEN
9		MAGENTA
11		ORANGE

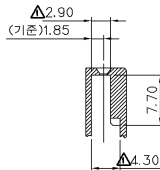
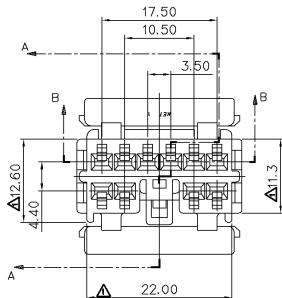

VIEW C-C

GENERAL TOLERANCE (HOUSING)							USED ON
10MAX	50MAX	100MAX	250MAX	250VR	ANGLE	ECCENT	
±0.2	±0.3	±0.55	±0.95	±1.4	±30'	0.1	

NOTE

1. APPLICABLE TERMINAL : ST730497-3, ST730497(Au)  
ST730498-3, ST730498(Au)
2. APPLICABLE HOUSING : MG620405(7122-8307)
3. HAZARDOUS SUBSTANCES IN PARTS (LEAD, MERCURY, CADMIUM, HEXAVALENT CHROMIUM, PBBs, PBDEs) SHALL NOT EXCEED THE MAXIMUM PERMISSIBLE CONCENTRATION PRESCRIBED UNDER EU ELV DIRECTIVE & RoHS REGULATION.

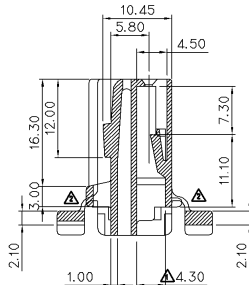
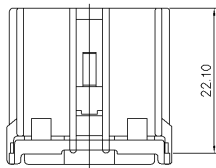
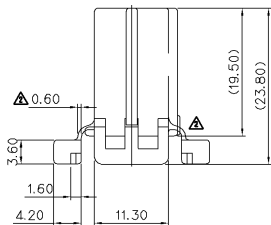

SECTION A-A

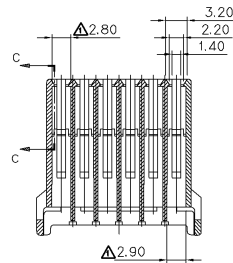

SECTION B-B

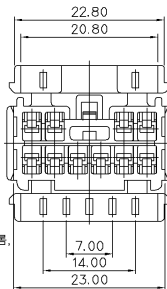

주 기

1. 적용 TERMINAL : ST730497-3, ST730497(Au)  
ST730498-3, ST730498(Au)
2. 적용 HOUSING : MG620405(7122-8307)
3. 제품내 함유된 6대 유해물질 (납, 수은, 카드뮴, 6가크롬, PBBs, PBDEs)은 EU ELV 지침 및 RoHS 법규에서 지정한 최대 허용 농도를 초과해서는 안된다.



ISSUE MARK

		MATERIAL	SEE TABLE	<b>KET</b> KOREA ELECTRIC TERMINAL CO., LTD.		
		FINISH	SEE TABLE			
△ 설계변경이유(사수(20231)년 2차 재평 △ 판이후기 △ 판이후기	DATE	08.09.22	WIRE RANGE	CLASS	070	
	DR	00.11.09	INSULATION	TYPE		
LTR	REVISION RECORD	DR	CHK	APP	DATE	
DR	KKJ. 91.12.03	CHK	APP	DATE	SCALE	2/1
CHK		APP			PART NO.	MG610404
		PART NAME		SDL 10F HOUSING		